

# NEW RELEASE!

## CE8000 SERIES

### CE8000-40 / 60 / 130

Enhanced basic specifications and excellent cost-effectiveness



### New Control Panel

- Touch Screen AND Mechanical Keys
- New Menu Structure
- Integrated Firmware Updates

### Wireless LAN

Wireless LAN connection option improves flexibility of installation locations

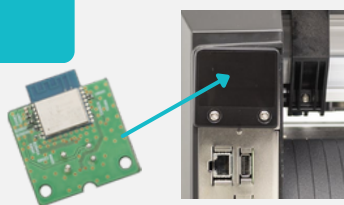

### New ARMS 9.0

(Advanced Registration Mark System) for multiple print & cut applications

### New Blade holder/Mount

New Holder design makes it easier to change tools and blade position by sliding the stopper forward and back



### Redesigned Tool Holder

Tool compartment now has a magnetic base making it easy to move location and allows option to remove if needed



### New Basket

CE8000 SERIES

# CE7000 / CE8000 Differences



## New Control Panel

### NEW TOUCH PANEL with MECHANICAL KEYS

This feature gives users more flexibility with its Blind Touch Operation enabling the operator to continually keep eyes on media while feeding

### NEW MENU STRUCTURE

Revisions to the menu are more intuitive and efficient utilizing the new touch screen feature with icons that allow easier operation.



## Blind Touch Operation

Intuitive operability accelerates workflow

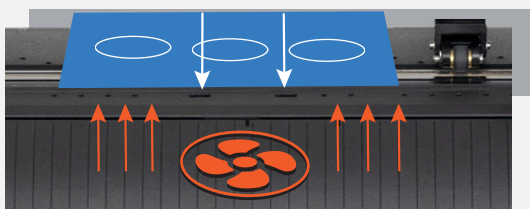

## New Media Assist

The CE8000 internal fan automatically turns on as sensor recognizes media to support feeding

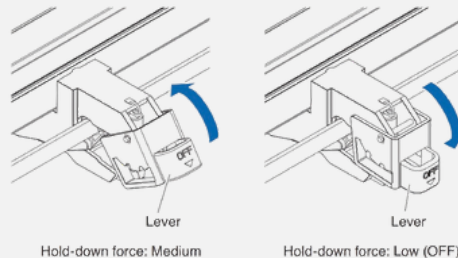

## New Push-roller Design

The CE8000 series features adjustable hold-down force with fixed force at the ends (5.5kg) and switchable centre rollers (3.2kg), higher force than that of CE7000



## New Blade Holder Design

PHP33-CB09N/15N exterior design has changed to match the more refined styling of the CE8000.

## Revised Accessories

### Accessories removed from the CE8000:

- Blade Loupe
- Fibre-tip Pen / Holder
- USB Cable

### Optional Accessories:

- Media Basket
- Carrier Sheet Table
- Blade Loupe
- Fibre-tip Pen / Holder
- Roll Media Tray
- USB Cable

## Easy Firmware Updates

- Check for New Firmware using Software Download /Update via Wireless LAN or USB
- Update New Firmware using a thumb drive when operating without network connection